

MIL 67-68

DOUBLE ACTING PISTON CYLINDER ACTUATORS

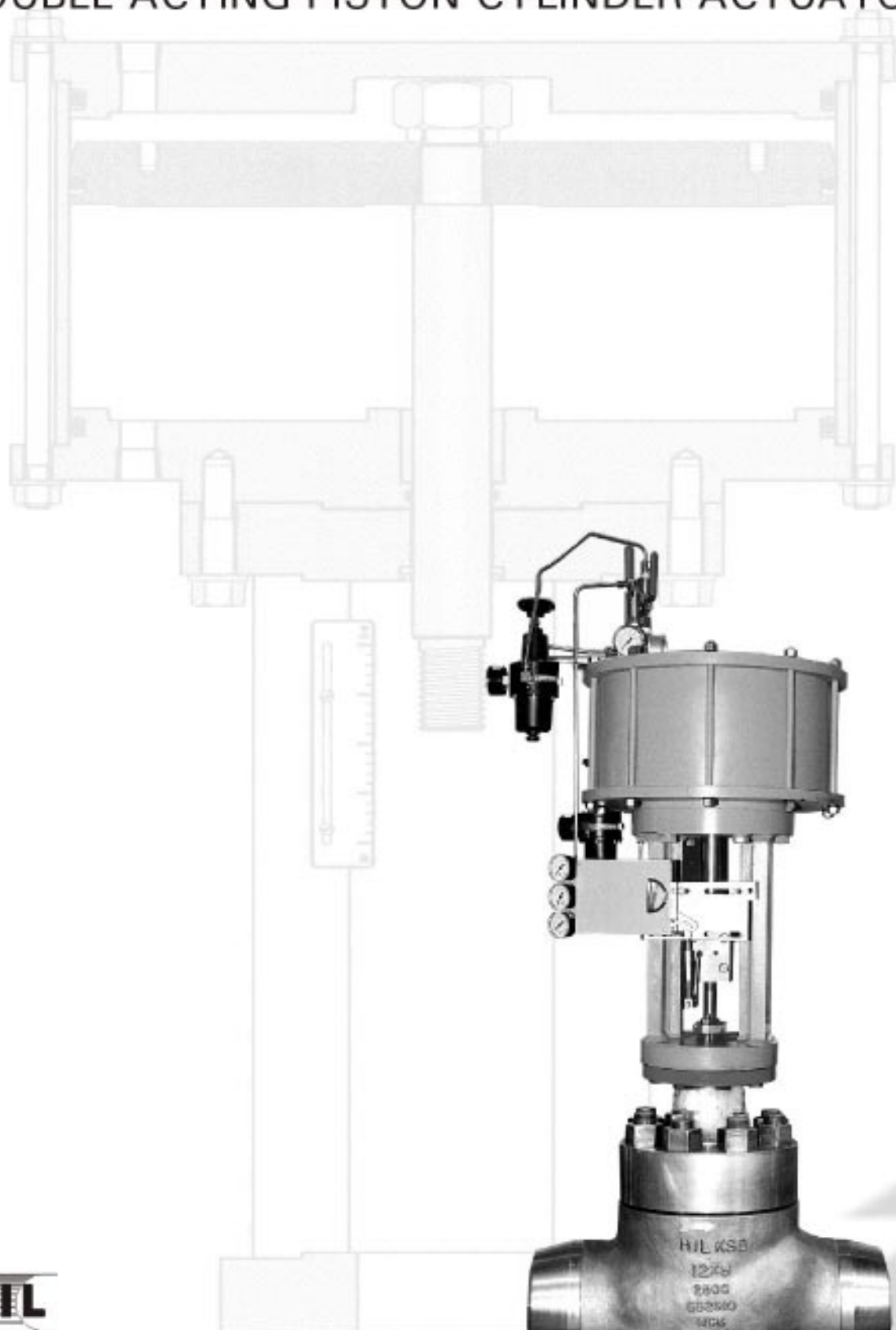

MIL Controls Limited

TABLE OF CONTENTS

Numbering System	2
General Data	2
Construction Drawing	3
Material of Construction	4
Allowable Shut-Off Thrust (Air-to-Open actuators).....	5
Allowable Shut-Off Thrust (Air-to-Close actuators).....	6

FOREWORD

The MIL 67/68 Double Acting Piston Cylinder Actuator is a high-power, high-performance, pneumatic actuator that provides either positive throttling or on-off operation for automatic control valves. These actuators & positioners have the capability to work upto 100 psi, making very high thrust obtainable from a small and compact unit. Positioners are normally yoke mounted and double acting type, which, by providing air to both sides of the piston, give an exceptionally stiff and precise unit which is resistant to load fluctuations and transients and has very high frequency response.

KEY FEATURES INCLUDE.

WIDE RANGE OF STROKES AND SIZES

To actuate entire range of sliding stem control valves, actuators are available from 1½" to 12" strokes. Higher strokes available on request. Actuators available in 16", 20" & 24" size to meet any thrust requirement.

HIGH THRUST CAPABILITY

100 psi operating pressure allows substantially higher thrust capabilities than other comparable actuators.

HIGH FREQUENCY RESPONSE

Double-acting configuration responds quickly to signal changes.

FIELD REVERSIBLE

Failure mode can be easily reversed without additional parts.

STABLE OPERATION

Supply pressure is sent to both sides of the piston for stable actuator operation.

FASTER TRAVEL

With faster response and the higher air supply pressures, travel times are lesser with piston cylinder actuators.

COMPACT AND LIGHTWEIGHT

MIL double acting piston cylinder actuators are substantially lighter and more compact than other comparable designs and are easier to install and maintain. Smaller size allows linear cylinder actuators to be installed in more positions.

DURABLE COMPONENTS

High quality materials require very little maintenance.

SIMPLE MAINTENANCE

Periodic maintenance is easy to perform with MIL's yoke-to-cylinder attachment system. Actuators have fewer parts and hence reduced inventory.

TIGHT SHUTOFF

High operating pressures (100 psi) ensures tight shutoff.

HIGH-LEVEL POSITIONAL STIFFNESS

Small air volume between the piston and the bottom of the cylinder provides powerful pneumatic snubbing-allowing high pressure, flow over the plug operation without plug slamming.

NUMBERING SYSTEM

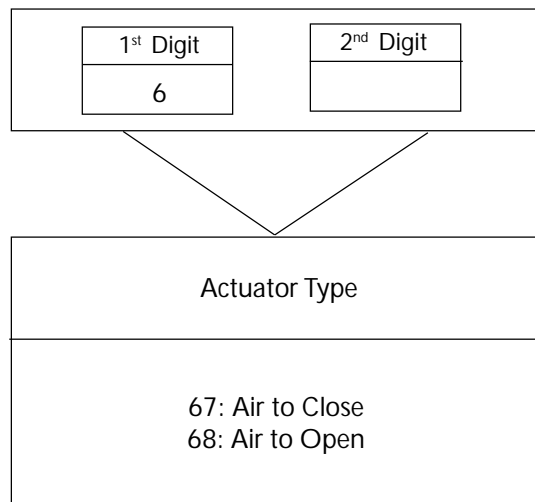

GENERAL DATA

MIL's Double Acting Piston Cylinder Actuator is a powerful pneumatic positioning actuator, which incorporates the following features.

- Accurate positioning in response to any common pneumatic controller signal.
- Sufficient stiffness to ensure stability under severe operating condition.
- Long strokes which ensure better controllability.
- Good dynamic response & High thrust capability.

TYPE
Double acting piston cylinder

AMBIENT TEMPERATURE LIMIT
82°C

ACTION
Direct or Reverse

SUPPLY PRESSURE
Upto 100 psi

ACTUATOR SIZES
16" , 20" , 24"

HANDWHEEL
Gear Drive Operated Worm Handwheel

CONSTRUCTION

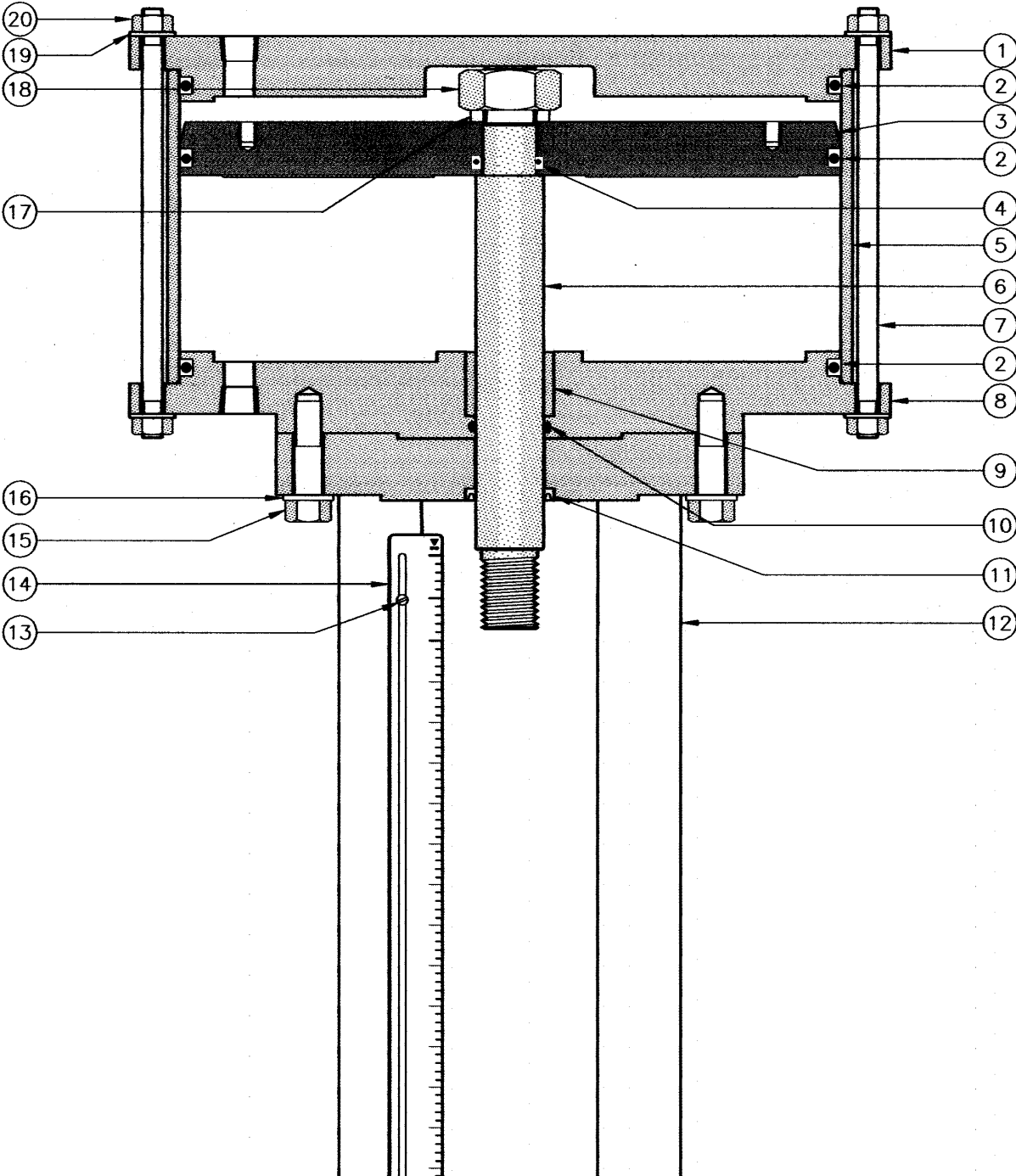

MATERIAL OF CONSTRUCTION

Ref. No.	Part Description	Material
1	Upper Cover	IS 2062
2	'O' Ring	Nitrile Rubber
3	Piston	IS 2062
4	'O' Ring	Nitrile Rubber
5	Cylinder	Carbon Steel
6	Piston Rod	SS 410
7	Tie Rod	Carbon Steel
8	Lower Cover	IS 2062
9	Guide Bush	IS 318 Gr. 2
10	'O' Ring	Nitrile Rubber
11	Oil Seal	-
12	Yoke	IS 2062
13	Screw	SS
14	Stroke Scale	SS
15	Bolt	EN8
16	Washer	EN8
17	Spring Washer	-
18	Nut	EN8
19	Washer	EN8
20	Nut	EN8

For other material, consult MIL. MIL reserves right to provide superior material, owing to continuous product upgrading.

TYPE-68 ACTUATORS: ALLOWABLE SHUT-OFF THRUST (AIR-TO-OPEN)

Act. Size	Stem Travel (Inch)	Thrust w/o Volume Tank				Thrust with 20 liter Volume Tank			
		Supply 60psi		Supply 100psi		Supply 60psi		Supply 100psi	
		lbs	Kg	lbs	Kg	lbs	Kg	lbs	Kg
16"	1½	6324	2869	12090	5484	7812	3544	13950	6328
	2	5580	2531	10230	4640	7254	3290	13392	6075
	4	1860	844	4650	2109	5394	2447	10416	4725
	6	-	-	-	-	3720	1687	7812	3544
20"	2	9452	4287	17792	8070	10842	4918	19460	8827
	4	5004	2270	10564	4792	7784	3531	15290	6936
	6	834	378	4170	1892	5004	2270	11120	5044
	8	-	-	-	-	2502	1135	6394	2900
24"	6	6834	3100	14874	6747	9246	4194	18492	8388
	8	2814	1276	8040	3647	6030	2735	13266	6017
	10	-	-	1608	729	2814	1276	8040	3647
	12	-	-	-	-	-	-	2814	1276

TYPE-67 ACTUATORS: ALLOWABLE SHUT-OFF THRUST (AIR-TO-CLOSE)

Act. Size	Stem Travel (Inch)	Thrust w/o Volume Tank				Thrust with 20 liter Volume Tank			
		Supply 60psi		Supply 100psi		Supply 60psi		Supply 100psi	
		lbs	Kg	lbs	Kg	lbs	Kg	lbs	Kg
16"	1½	7626	3459	15252	6918	8370	3797	15810	7171
	2	7068	3206	14694	6665	8184	3712	15624	7087
	4	2604	1181	11160	5062	7254	3290	14694	6665
	6	-	-	-	-	5952	2700	13392	6075
20"	2	9174	4161	22518	10214	12232	5548	23352	10592
	4	8340	3783	19460	8827	10842	4918	21962	9962
	6	-	-	10008	4540	8618	3909	19738	8953
	8	-	-	-	-	4448	2018	15568	7062
24"	6	12000	-	28000	12701	14472	6564	30552	13858
	8	4800	-	20800	9435	10854	4923	25326	11488
	10	-	-	-	-	4824	2188	20904	9482
	12	-	-	-	-	-	-	7638	3465



MIL Controls Limited A KSB Company



REGD. OFFICE & WORKS

Meladoor, Mala
PIN 680 741, Thrissur Dist., Kerala, India
T: 91 (0)488 890272, 890772, 891773
F: 91 (0)488 890952
E: milf@vsnl.com

MARKETING HEAD OFFICE

P. B. No. 04, Aluva
PIN 683 101, Ernakulam Dist, Kerala, India
T: 91 (0)484-624955, 624876
F: 91 (0)484-623331
E: ksbmil@sancharnet.in, milksb1@vsnl.net

BRANCH OFFICES

NEW DELHI
MIL Controls Limited
KSB House, A-96, Sector 04,
Gautam Budh Nagar,
Noida 201 301, India
Tel: 91 (0)120 4541091 to 93, 4541501 to 03
Fax: 91 (0)120 4550567, 4525626
Email: ksbdel@ndf.vsnl.net.in

MUMBAI
MIL Controls Limited
Batra House, 2nd Floor, Saki Naka,
Andheri (E),
Mumbai 400 072, India
Tel: 91 (0)22 8528614 to 15, 8528617
Fax: 91 (0)22 8528618
Email: milmum@bom3.vsnl.net.in

CALCUTTA
MIL Controls Limited
2nd Floor, 30 Circus Avenue,
Calcutta 700 017, India
Tel: 91 (0)33 2470473, 2400117, 2400418
Fax: 91 (0) 33 2470588
Email: milcal@vsnl.net

CHENNAI
MIL Controls Limited
Guindy House, 2nd Floor,
95, Annai Salai,
Chennai 600 032, India
Tel: 91 (0) 44 2352571 to 72, 2300629
Fax: 91 (0) 44 2352749
Email: che-mil@ksb.co.in

VADODARA
MIL Controls Limited
4-B, Ramakrishna Chambers,
Productivity Road,
Vadodara 390 005, India
Tel: 91 (0)265 330532, 333226
Fax: 91 (0)265 314693
Email: ksbad1@sancharnet.in

POONA
MIL Controls Limited,
Sawant Nivas, 1194/7 Ghole Road,
Near Ramachandra Mandap, Shivaji Nagar,
Poona 411 005, India
Tel: 91 (0)20 5536345, 5536347, 5530012
Fax: 91 (0)20 5536349
Email: ksbpune@vsnl.net

OVERSEAS SALES OFFICES

AUSTRALIA
KSB Ajax Pumps Pty Ltd,
27 Indwe Street, Tottendam,
Victoria 3012, Australia
Tel: (61-3) 9314 0611
Fax: (61-3) 9314 7435
Email: ksbcentra@ksbajax.com.au

CHINA
KSB-AMRI BEIJING,
Unit 1102, The Gateway,
No. 10 Yabao Road, Chao yang District,
Beijing 100020, China
Tel: (86-10) 6591 5768
Fax: (86-10) 6591 5769
Email: amribj@public.fhnet.cn.net

FINLAND
Mercantile KSB Oy Ab,
Tuotekatu 04, FIN 33840
TAMPERE, Finland
Tel: 358 9 3450 5112
Fax: 358 9 3450 5123
Email: ansisi.lahti@ksb.mercantile.fi

HONG KONG
KSB Limited,
17/F, Chuang's City Tower,
39 Morrison Hill Road,
Causeway Bay, Hong Kong
Tel: 852 2147 1220
Fax: 852 2147 1230
Email: ksb_hk@pacific.net.hk

INDONESIA
PT KSB
J1 Boulevard, Timur Block,
NC 1/53, Kelapa Gading Permai,
Jakarta 13220, Indonesia
Tel: 62-21 4584 2070
Fax: 62-21 4584 2071
Email: ksbindo@centrin.net.id

SOUTH KOREA
KSB Korea Ltd,
6F, Doo Kyong Building,
6401 Hannam - Dong, Yongsan - Ku,
Seoul, South Korea
Tel: 82-2 790 4351
Fax: 82-2 790 4350
E-mail: ksbkorea@ppp.komet.net

MALAYSIA
KSB AMRI Sdn Bhd,
65-2 Jalan 51/205, Highway Centre,
4605 Petaling Jaya,
Selangor Darul Ehsan, Malaysia
Tel: 60-03 7781 3026
Fax: 60-03 7781 3020
Email: ksbamri@pd.jaring.my

SINGAPORE
KSB AMRI (Asia Pacific) Pte Ltd
25 Tagore Lane, 02-08/09
Singapore Godown, Singapore 787602
Tel: 65 555 0366
Fax: 65 553 3500
Email: sales@ksb-amri.com.sg

SOUTH AFRICA
KSB Pumps (S.A) Pty Ltd,
P.O. Box 2938, Primrose 1416,
Cor. North Reef & Activia Road, Activia Park,
Germiston, South Africa
Tel: 27-11 828 8950
Fax: 27-11 282 0244
Email: valves@ksbpumps.co.za

TAIWAN
KSB Taiwan Co Ltd,
19F Room A 1, Taiwan Leaders Center,
No. 29, Hai-Pien Road, Kaohsiung, Taiwan RO
Tel: 886-7 330 7724
Fax: 886-7 330 7548
Email: ksbkhh@ksmail.seed.net.tw

